



BOSCH 	1 928 A00 17M-E	1st Use (Item): Cable harness plug 6-pin for LSU 4.9
	Installation Specification for Assembly	Sheet: 1 of 9

No.	Change	Sig.	Valid	Ckd.		Datum/	Name/	
						Sig./	30.07.01	Da
						Ckd./	30.07.01	Pd
						Rev./	30.07.01	Sc
						Original:	WaW/TEF23	
03	Editorial alteration	Pd	30.06.05	Rb		Master file:	GS-CP/ENG-Ablage	
02	Variant CPA added	Co	02.09.04	Pd				
01	First edition	Da	30.07.01	Pd				

Table of Contents:

Point	Contents	Page
1.	General	2
1.1	Presentation of the 6-pin cable harness plug	2
2.	Assembly of the 6-pin cable harness plug	3
2.1	As-delivered condition	3
2.2	Assembly of the contacts	4
2.3	Equipping of the chambers	4-6
2.4	Installation of the secondary latch in the end position	7
3.	Removal of the contacts from the 6-pin plug housing	8
3.1	Removal of the contacts from the plug housing	8
4.	Variant of the 6-pin cable harness plug with CPA	9
4.1	As-delivered condition	9

BOSCH 	1 928 A00 17M-E	1st Use (Item): Cable harness plug 6-pin for LSU 4.9
	Installation Specification for Assembly	Sheet: 2 of 9

1. General

1.1 Presentation of the 6-pin Cable Harness Plug

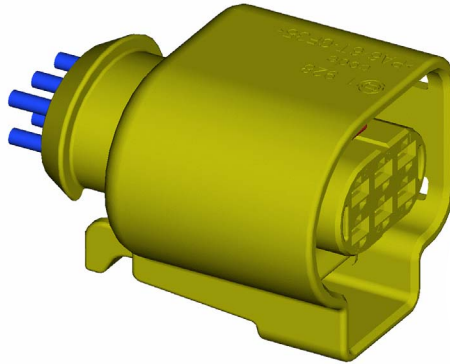

Fig.1.1 Assembled presentation

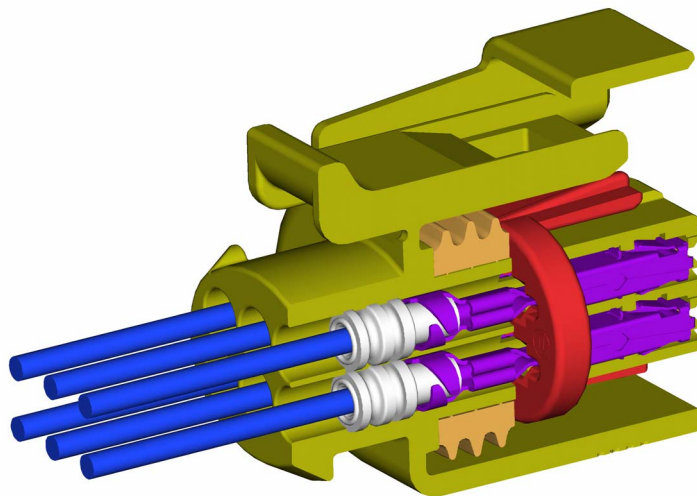



Fig.1.2 Cross-section of assembled presentation

BOSCH 	1 928 A00 17M-E	1st Use (Item): Cable harness plug 6-pin for LSU 4.9
	Installation Specification for Assembly	Sheet: 3 of 9

2. Assembly of the 6-Pin Cable Harness Plug

2.1 As-Delivered Condition

Cable harness plug in accordance with Offer Drawing 1 928 A00 039

Item	Name
1	Plug housing
2	Secondary latch
3	Flat contact MCP 1,5K (QKK)
4	Individual conductor seal
5	Radial seal

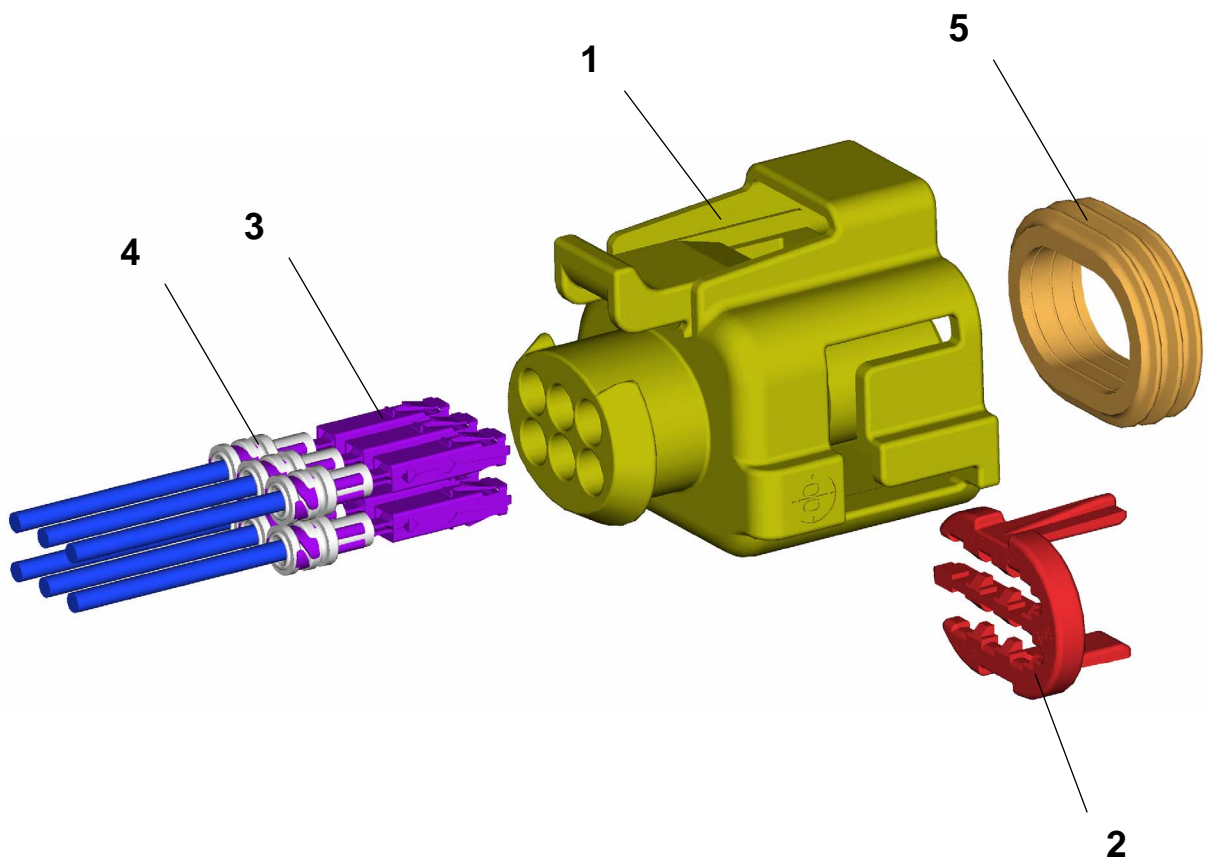



Fig. 2.1 Exploded presentation

BOSCH 	1 928 A00 17M-E	1st Use (Item): Cable harness plug 6-pin for LSU 4.9
	Installation Specification for Assembly	Sheet: 4 of 9

2.2 Assembly of the Contacts

The contacts to be used are to be taken from the Offer Drawing (see Point 2.1).

Assembly of the contacts in accordance with the handling specification from the contact manufacturer.

2.3 Equipping of the Chambers

The premounted contacts are introduced horizontally into the particular chambers (Fig.2.2) until the primary latch has snapped into the chamber of the plug housing on both sides (Fig. 2.5).

After latching of the contact, attention is to be paid to ensure that the individual conductor seal with the flat contact is in the correct position. The secondary latch is then pushed into the pre-latched position (Fig.2.3).

Attention:

- The flat plug and its surface may not be damaged during this operation.
- The contacts and the insulation of the electrical lines as well as the individual conductor seals may not be damaged.

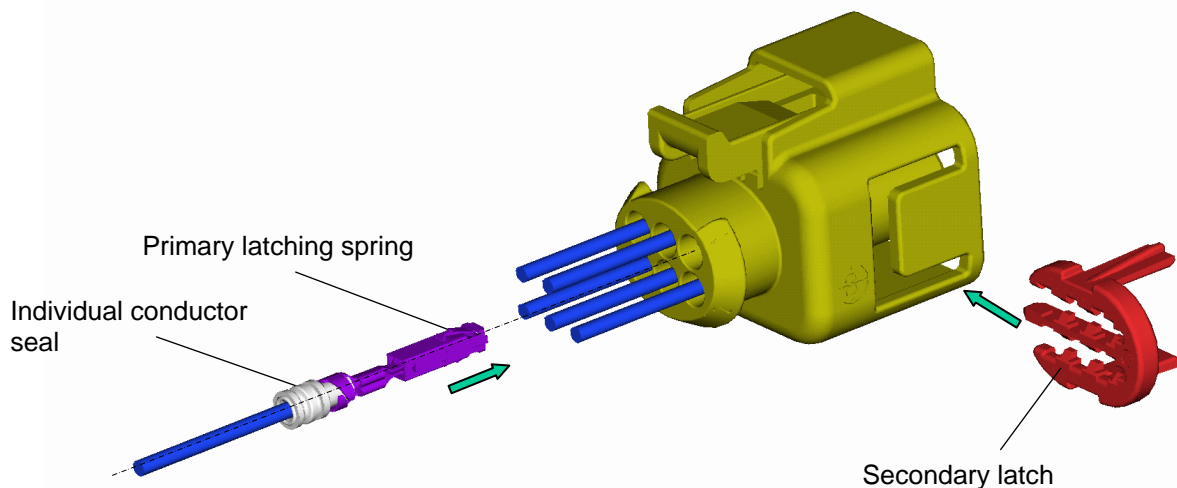



Fig. 2.2 Orientation contact to the plug housing

BOSCH 	1 928 A00 17M-E	1st Use (Item): Cable harness plug 6-pin for LSU 4.9
Installation Specification for Assembly		Sheet: 5 of 9

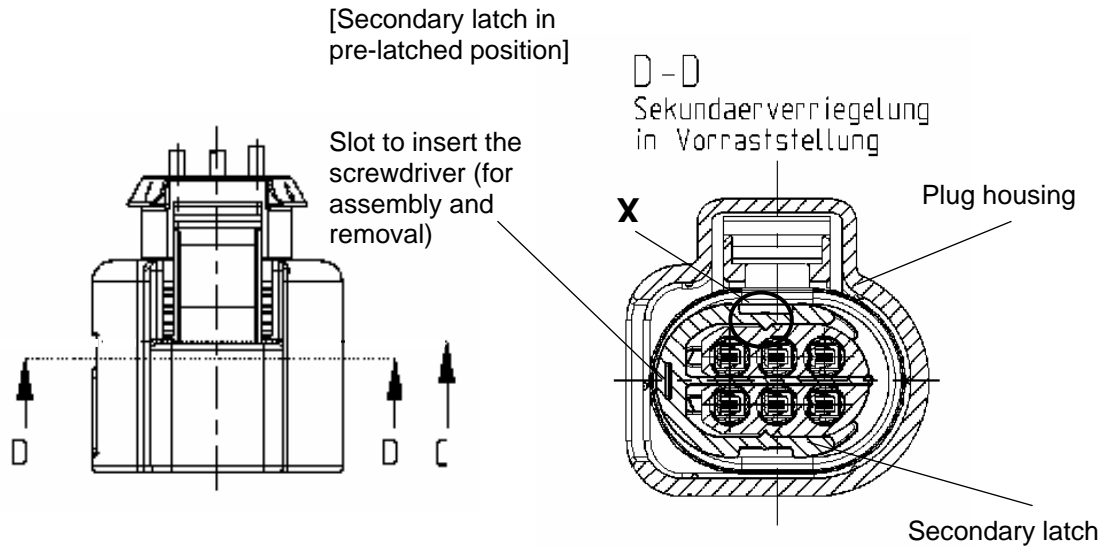

Fig. 2.3 Secondary latch in pre-latched position

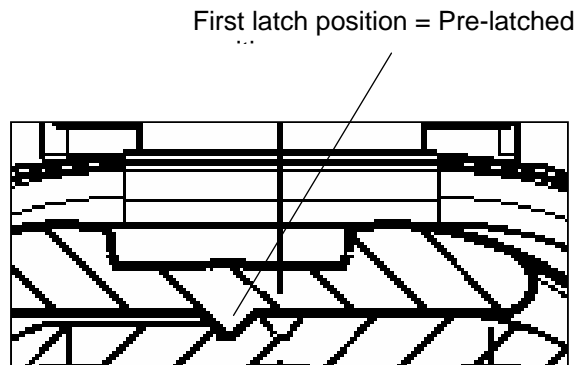



Fig. 2.4 Detail X

BOSCH 	1 928 A00 17M-E	1st Use (Item): Cable harness plug 6-pin for LSU 4.9
Installation Specification for Assembly		Sheet: 6 of 9

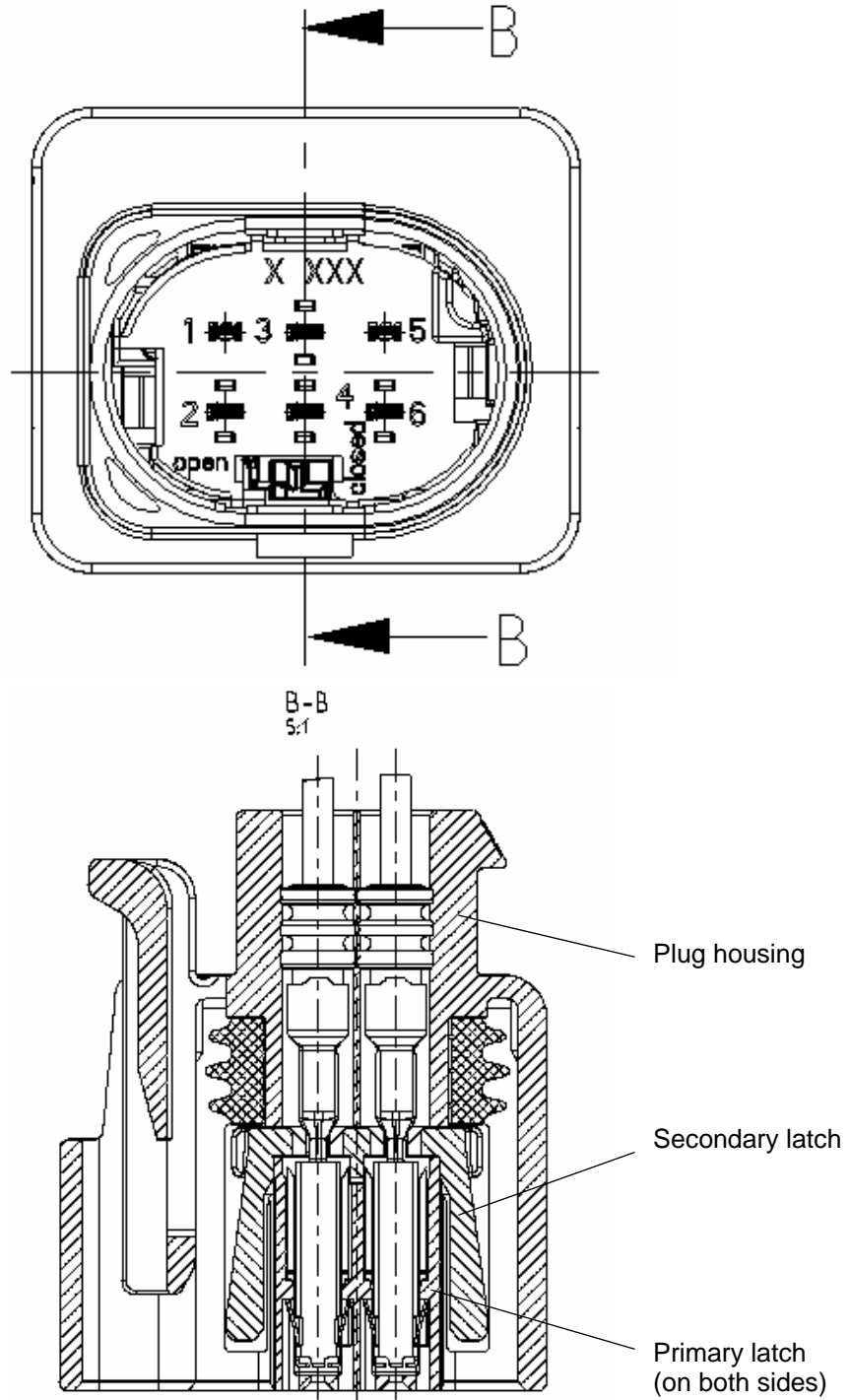



Fig. 2.5 Contact in chamber of the plug housing

BOSCH 	1 928 A00 17M-E	1st Use (Item): Cable harness plug 6-pin for LSU 4.9
		Installation Specification for Assembly

2.4 Installation of the Secondary Latch in the End Position

When all contacts have been correctly inserted, the secondary latch must be pushed from the pre-latched position (Fig.2.3) into the end position (Fig.2.6). The secondary latch is pushed with the use of a blunt screwdriver (Fig. 2.6) which moves the secondary latch with a max. force of $\leq 30\text{N}$ in the sliding direction until the secondary latch has snapped into the end position. If the max. force is exceeded and the end position is not reached, the contacts are not positioned correctly. The secondary latch must then be moved back into the pre-latched position again, after which all contacts are checked for correct position and positioned correctly if necessary. Then proceed as described above.

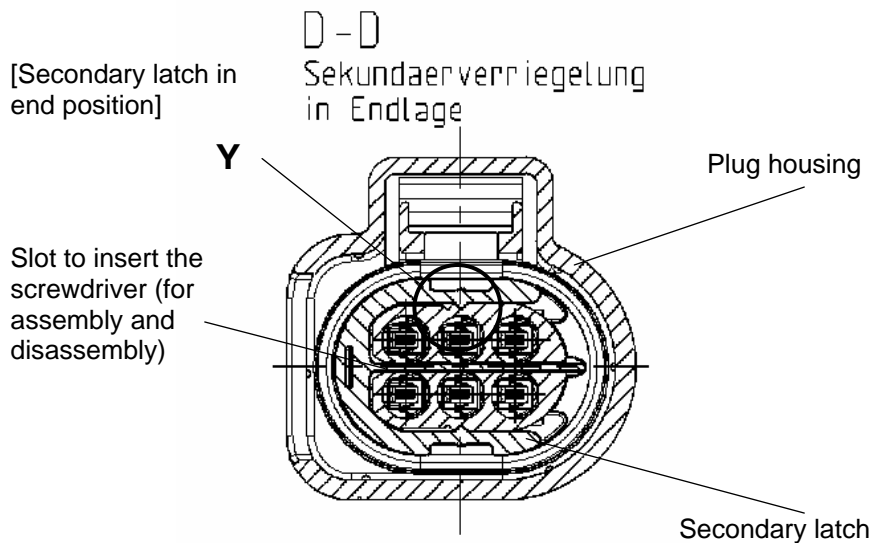
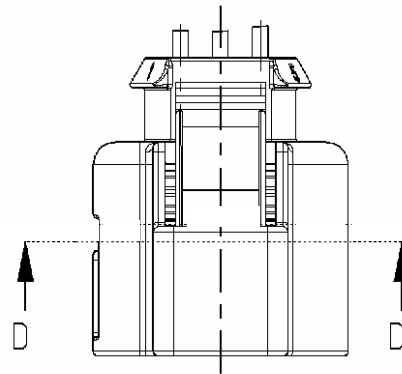



Fig.2.6 Secondary latch in end position

Second latch position = End position



Fig.2.7 Detail Y

BOSCH 	1 928 A00 17M-E	1st Use (Item): Cable harness plug 6-pin for LSU 4.9
		Installation Specification for Assembly

3. Removal of the Contacts From the 6-Pin Plug Housing

First of all, the secondary latch must be pushed from the end position (Fig.2.6) into the pre-latched position (Fig.2.3).

3.1 Removal of the Contacts From the Plug Housing

Instructions for Use:

1. Insert the correct unlatching tool into the appropriate unlatching opening of the plug housing.
Attention: Do not push to the stop yet.
2. Press the contact on the electrical line in the direction of the unlatching tool and hold in this position.
3. Insert the unlatching tool completely.
4. Pull the contact carefully on the electrical line. In case of difficult movement, repeat the entire operation.

Attention:

- In case of difficult movement, do not pull forcefully on the electrical line. Otherwise, the primary spring of the contact will be seized or damaged.
- Disassembled contacts must be replaced by new ones.
- The contacts and the insulation of the electrical lines as well as the individual conductor seals may not be damaged.

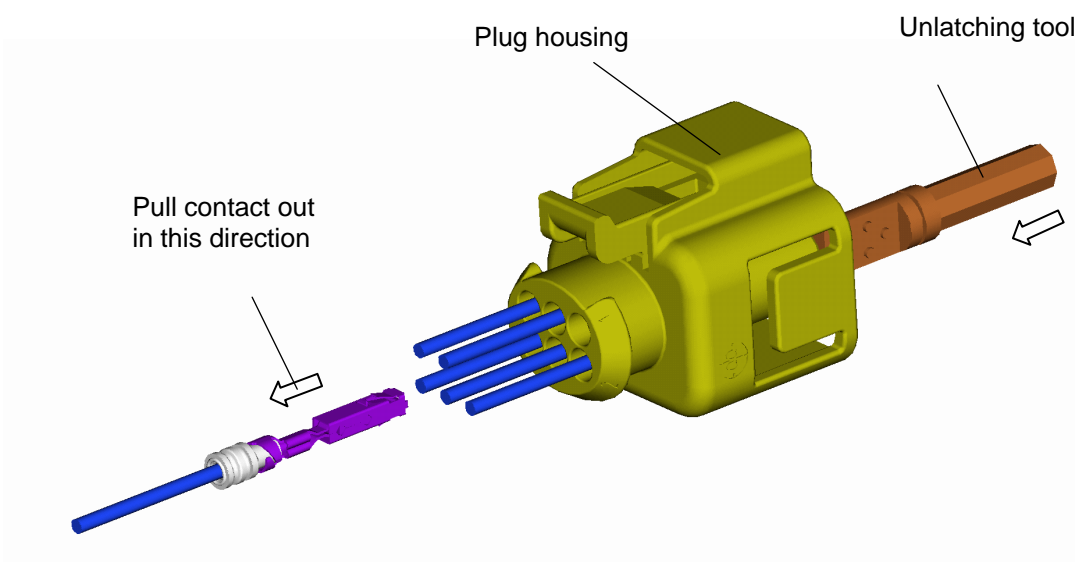



Fig. 3.1 Removal of the contacts

BOSCH 	1 928 A00 17M-E	1st Use (Item): Cable harness plug 6-pin for LSU 4.9
	Installation Specification for Assembly	Sheet: 9 of 9

4. Variant of the 6-pin cable harness plug with CPA

4.1 As-delivered condition

Cable harness plug with CPA in accordance with Offer Drawing 1 928 A00 039, see Point 2.1

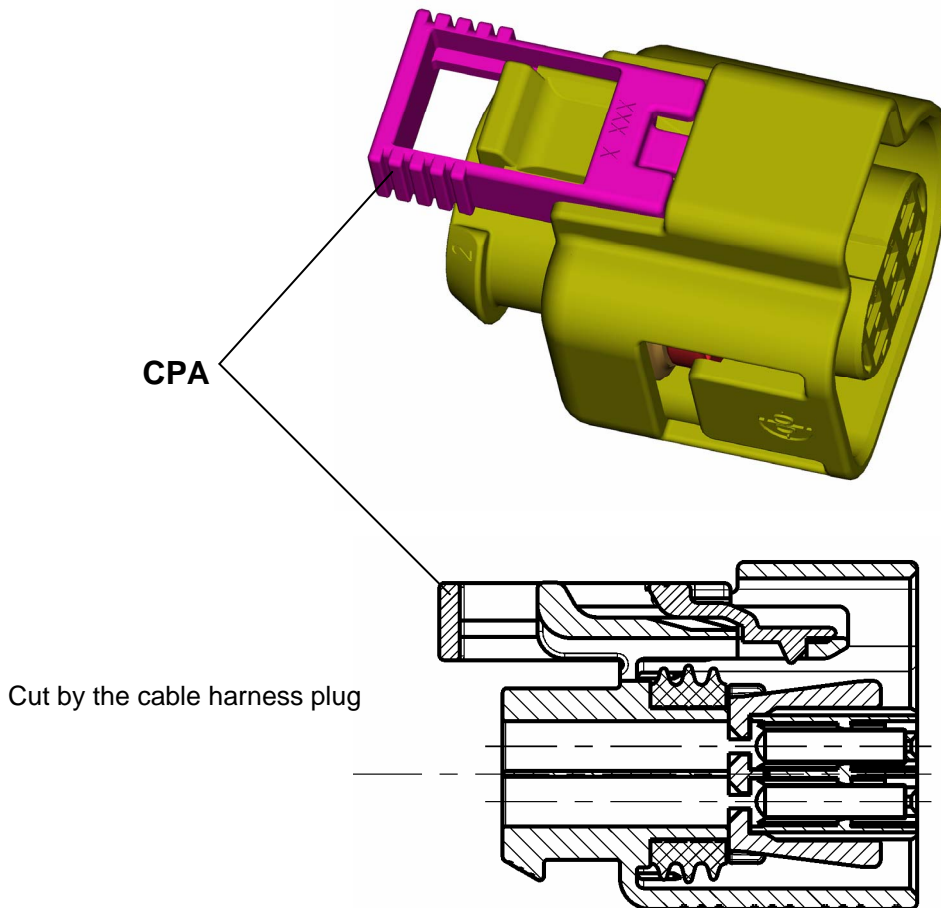

Fig. 4.1 As-delivered condition, CPA premounted

ATTENTION:

It is **not** allowed to move out the CPA, during the processing (assembly of contacts, etc.) at contact manufacturer, of the as-delivered condition.

It is forbidden to move, manipulate, actuate, press , deform, damage etc. the CPA .