

2.54mm (.100") Pitch MX64™ Sealed Connectors

31403 Single Row Female

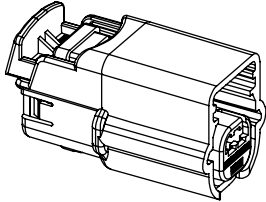

Features and Benefits

- Meets all USCAR footprints and testing requirements
- Matte seal design
- Available with or without CPA
- Polarization options available

Reference Information

Packaging: Bag
Mates With: Direct connect only
Designed In: Millimeters

Electrical

Voltage: 250V
Current: 11.0A max.
Contact Resistance: 20 milliohms max.
Dielectric Withstanding Voltage: 500V DC
Insulation Resistance: 20 Megohms min.

Mechanical

Contact Insertion Force: 30N max.
Contact Retention to Housing: 90N min.
Mating Force: Less than 75N
Unmating Force: Less than 75N

Physical

Housing: Glass-filled PBT
Contact: Tin or Gold
Wire Gauge: 18 to 22 AWG

Order No.		Rows/Circuits	Polarization	Color
Without CPA	With CPA			
31403-2100	31403-2110	1x2	A	Black
31403-2200	31403-2210		B	Gray
31403-2300	31403-2310		C	Brown
31403-2400	31403-2410		D	Green
31403-2500	31403-2510		B	Black
31403-2600	31403-2610		C	
31403-2700	31403-2710		D	
31403-3100	31403-3110		A	
31403-3200	31403-3210	1x3	B	Gray
31403-3300	31403-3310		C	Brown
31403-3400	31403-3410		D	Green
31403-3500	31403-3510		B	Black
31403-3600	31403-3610		C	
31403-3700	31403-3710		D	
31403-6100	31403-6110		A	
31403-6200	31403-6210		1x6	B
31403-6300	31403-6310	C		Brown
31403-6400	31403-6410	D		Green
31403-6500	31403-6510	B		Black
31403-6600	31403-6610	C		
31403-6700	31403-6710	D		

2.54mm (.100") Pitch
MX123™
Sealed Connection System
0.64mm Terminal
33467/33468

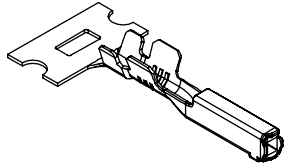

Features and Benefits

- Precious plating ensures stable contact resistance under extreme temperature and vibration conditions

Reference Information

Packaging: Reel
 Mates With: 73- and 80-Circuit Receptacle (Series 34566)
 56 Receptacle (Series 34576)

Electrical

Voltage: 500V max.
 Current: 0.64mm (.025")—11.0A max.
 Contact Resistance: 0.64mm (.025")—20 milliohms max.
 Dielectric Withstanding Voltage: 1500V AC
 Isolation Resistance: 20 Megohms min.

Mechanical

Durability—10 Cycles:
 0.64mm (.025")—20 milliohms max.
 FCLT (Class 3): 20 milliohms max.
 Thermal Shock (Class 3, 100 cycles):
 0.64mm (.025")—20 milliohms max.
 Mechanical Shock and Vibration Sequence
 (GMW3191, Electrical):
 0.64mm (.025")—20 milliohms max.

Physical

Contact: Copper Alloy
 Terminal Plating:
 Contact Area: 0.64mm (.025")—Gold
 Underplating: 0.64mm (.025")—Nickel

Order No.	Size (mm)	Plating	Wire Size (AWG)	Payoff Direction
33467-0004	0.64	Gold	22	D
33467-0003				B
33467-0006			18 to 20	D
33467-0005				B
33468-0002		Tin	22	D
33468-0001				B
33468-0004			18 to 20	D
33468-0003				B

2.54mm (.100") Pitch
MX123™
Sealed Connection System
Cavity Plug
34586

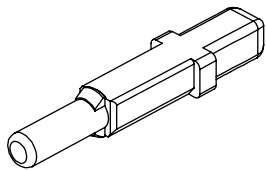

Reference Information

Packaging: Bulk
 Use With: 73- and 80-Circuit Receptacle (Series 34566)
 56 Circuit Receptacle (Series 34576)

Mechanical

Insertion Force: Less than 40N (9 lb)

Physical

Material: 30% glass-filled SPS/Nylon Blend

Order No.	Assembly Features	Size (mm)
34586-0001	Lock Tab and Forward Stop	0.64mm terminal