

注記

- 1. 嵌合相手品番 : 7114-4231-02, 7114-4231-08
- 2. 適用電線サイズ : CAVUS 0.3~CAVS 0.5
- △ 3. () 内品番は、エアバッグ (A/B) 回路及び特別管理回路に使用する時に適用すること。
- △ 4. 金めっき端子7116-4231-08 (7B16-4231-08) に適用する。

NOTES

- 1. MATING PART NO. : 7114-4231-02, 7114-4231-08
- 2. APPLICABLE WIRE SIZE : CAVUS 0.3~CAVS 0.5
- △ 3. PART NUMBERS IN PARENTHESIS SHALL BE USED FOR AIR BAG (A/B) CIRCUITS AND OTHER CIRCUITS DESIGNATED FOR SPECIAL MONITORING.
- △ 4. APPLIES TO GOLD-PLATED TERMINAL 7116-4231-08 (7B16-4231-08).

PART NO. AND CH. CODE	TREATMENT
7116-4231-08, △ (7B16-4231-08, △)	△ 3 GOLD PLATING △ 1 TIN PLATING
7116-4231-02 △ (7B16-4231-02)	TIN PLATING

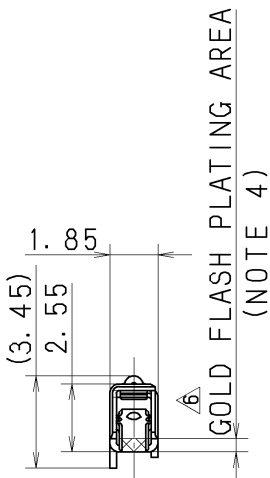
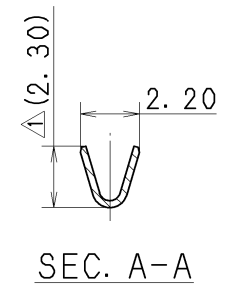
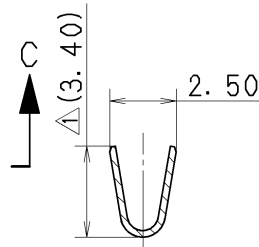
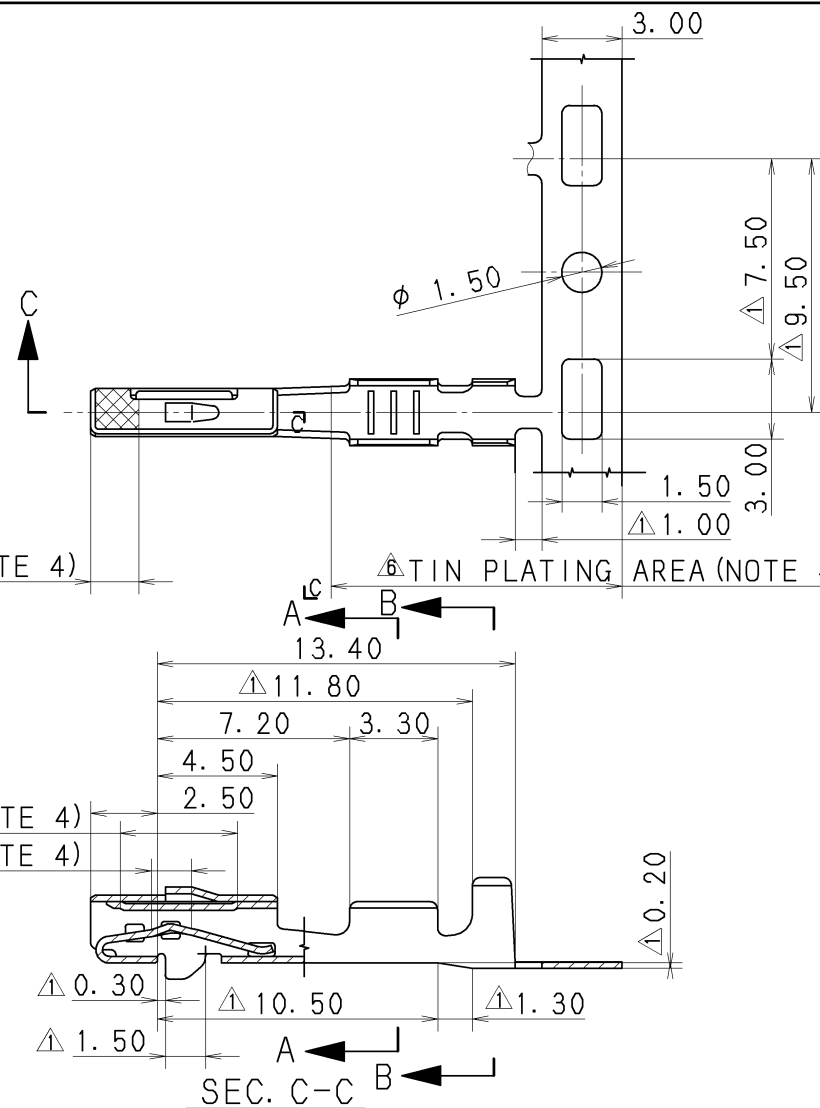

△ GOLD PLATING AREA (NOTE 4)

△ TIN PLATING AREA (NOTE 4)

△ GOLD PLATING AREA (NOTE 4)

△ GOLD PLATING AREA (NOTE 4)

SEC. C-C

ISSUE MARK

△	09/01/16	ADDED NOTE ETC.	C09-Z028	T. O
△	05/11/15	CHANGED PART NAME	C05-ZF35	T. O
△	03/07/25	ADDED A/B PART NO.	C03-X494	Y. I
△	01/10/24	CHANGED TREATMENT & PART NAME, △	C01-X908	E. F
△	98/11/12	ADDED NOTE & A/B PART NO.	C98-M817	T. H
△	98/07/18	CHANGED FORM, PLATING & DIMENSION	C97-N442	H. K
△	97/03/31	NEW	C97-L553	H. K
LET	DATE	REVISION RECORD	NO.	CHKD

GENERAL TOLERANCE								
	10MAX	50MAX	100MAX	250MAX	2500VR	ANGLE	ECCENT	
A	±0.15	±0.2	±0.3	±0.5	±0.75	±30'	0.1	
B	±0.2	±0.3	±0.55	±0.95	±1.4	±30'	0.1	
△ (C)	±0.3	±0.5	±0.8	±1.4	±2	±30'	0.15	
SPECIFIED							MASS	g

CUSTOMER		MATL. SPEC.		COPPER ALLOY (t=0.25)		TREAT. & FIN.	
CUSTOMER PART NO.		CUSTOMER DWG NO.		NAME		△ 1.0 III TERMINAL FEMALE	
OFFICE		TRIAL PART NO.		PART NO. CH. CODE		△ 7116-4231-08 ETC. (7B16-4231-08 ETC.)	
VENDOR		DWG TYPE		DWG SOURCE		DWG DATE	
VENDOR NO.		R		NEW		97/03/31	
APPROVED		CHECKED		CHECKED		DESIGN	
M. YAMANASHI		T. MIWA		T. OSADA		E. FUKUDA	
09/01/16		09/01/16		09/01/16		96/04/23	
DRAWN		R. BUCE		PART NO.		7116-4231-08 : R	
09/01/16		09/01/16		09/01/16		96/04/23	
SET DWG NO.		YAZAKI CORPORATION					