

GENERAL TOLERANCE											
	10 MAX	50 MAX	100 MAX	250 MAX	250 OVR	R5 MAX	R10 MAX	R20 MAX	R20 OVR	ANGLE	ECCENT
A	±0.15	±0.2	±0.3	±0.5	±0.75					±3°	0.1
B	±0.2	±0.3	±0.55	±0.95	±1.4	±0.2	±0.3	±0.5	±2.5	±3°	0.1
C	±0.3	±0.5	±0.8	±1.4	±2					±3°	0.15

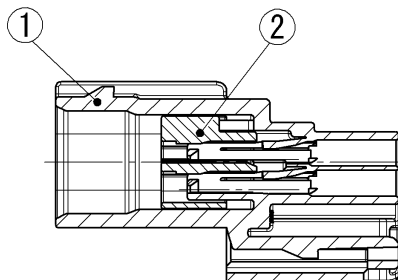

SEC. A-A

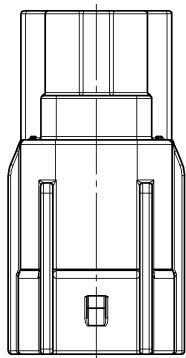
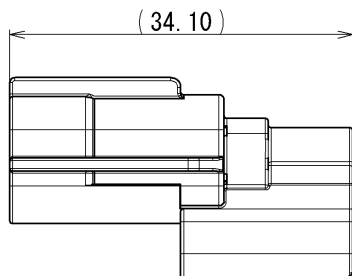
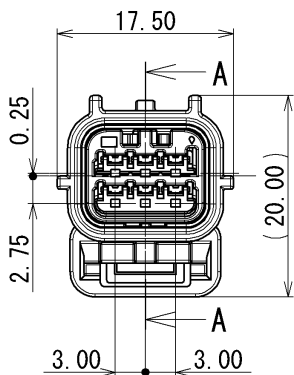

2

TABLE 1

SUB ASSEMBLY PART NO. AND CH. CODE	NO.	PART NO. AND CH. CODE	MATERIAL	COLOR	QTY.
△ 7282-2764-30 ETC.	①	△ SEE TABLE 2	PBT	△ SEE TABLE 2	1
	②	7158-6623	PBT-G	NATURAL	1

TABLE 2

SUB ASSEMBLY PART NO. AND CH. CODE	PART NO. AND CH. CODE	COLOR
△ 7282-2764	7182-2764	NATURAL
7282-2764-30	7182-2764-30	BLACK
△ 7282-2764-40	7182-2764-40	LIGHT GRAY

注記

- △ 1. かん合相手品番 : 7283-2764-30 ETC.
- 2. 適用端子品番 : 7114-4415-02
: 7114-4416-02
: 7114-4417-02
- 3. 適用ゴム栓品番 : 7158-3165-90
: 7158-3166-60
: 7158-3167-80
: 7158-3168-80
- 4. 適用防水栓品番 : 7158-3169-40

NOTES

- △ 1. MATING PART NO. : 7283-2764-30 ETC.
- 2. APPLICABLE TERMINAL NO. : 7114-4415-02
: 7114-4416-02
: 7114-4417-02
- 3. APPLICABLE SEAL RUBBER NO. : 7158-3165-90
: 7158-3166-60
: 7158-3167-80
: 7158-3168-80
- 4. APPLICABLE UNUSED CAVITY PLUG : 7158-3169-40

ISSUE MARK

△ 12/08/31	ADDED PART NO.	C12-Z787	E. I	CUSTOMER		MATL. SPEC.	SEE TABLE	TREAT. & FIN.							
△ 10/11/15	CHANGED PART NAME	C10-ZA95	G. M	CUSTOMER PART NO.	CUSTOMER DWG NO.	NAME △ HS 025 6P SEALED HOUSING									
△ 05/03/14	ADDED PART NO., ETC.	C05-Z400	K. N			SUB ASSEMBLY MALE									
△ 04/07/08	NEW	C04-Z729	K. N	OFFICE	TRIAL PART NO.	PART NO. CH. CODE △ 7282-2764-30 ETC.									
LET	DATE	REVISION RECORD	NO.	CHKD	VENDOR	DWG NO. 7282-2764-30:R									
GENERAL TOLERANCE					VENDOR NO.	SET DWG NO.									
	10MAX	50MAX	100MAX	250MAX	250OVR	ANGLE	ECCENT	DWG TYPE	DWG SOURCE	DWG DATE	UNIT	SCL	ANGLE	PART NO. CH. CODE △ 7282-2764-30 ETC.	
A	±0.15	±0.2	±0.3	±0.5	±0.75	±30°	0.1	R	NEW	04/07/08	mm	2:1	3	DWG NO. 7282-2764-30:R	
B	±0.2	±0.3	±0.55	±0.95	±1.4	±30°	0.1	APPROVED	CHECKED	CHECKED	DESIGN	DRAWN	YAZAKI CORPORATION		
C	±0.3	±0.5	±0.8	±1.4	±2	±30°	0.15	H. KANDA	K. SAWAIRI		K. NIIHO	E. ITALIA			
SPECIFIED					MASS			12/08/31	12/08/31		04/06/17	12/08/31			

1

2

3