

SEC. A-A

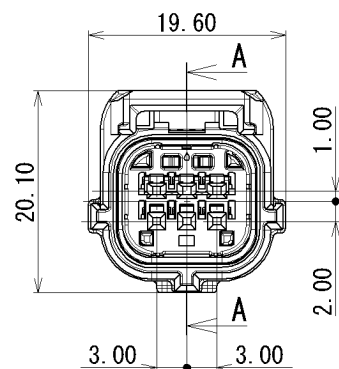

TABLE 1

SUB ASSEMBLY PART NO. AND CH. CODE	NO.	PART NO. AND CH. CODE	PART NAME	MATERIAL	COLOR	QTY.
SEE TABLE 2	①	SEE TABLE 2	HS 025 6P SEALED HOUSING FEMALE(OBD)	PBT	SEE TABLE 2	1
	②	7172-1523	HS 025 6P SEALED FRONT HOLDER FEMALE(OBD)	PBT	NATURAL	1
	③	7137-3154-80	HS 025 6P SEALED PACKING(OBD)	SILICONE RUBBER	BROWN	1

TABLE 2

SUB ASSEMBLY PART NO. AND CH. CODE	PART NO. AND CH. CODE	COLOR
7289-9553-30	7189-9553-30	BLACK
7289-9553-50	7189-9553-50	RED

注記

- 1. かん合相手品番 : 7288-9556-30
- 2. 適用端子品番 : 7116-4415-02、7116-4416-02、7116-4417-02
- 3. 適用ゴム栓品番 : 7158-3165-90、7158-3166-60、7158-3167-80、7158-3168-80
- 4. 適用防水栓品番 : 7158-3169-40

NOTES

- 1. MATING PART NO. : 7288-9556-30
- 2. APPLICABLE TERMINAL NO. : 7116-4415-02, 7116-4416-02, 7116-4417-02
- 3. APPLICABLE SEAL RUBBER NO. : 7158-3165-90, 7158-3166-60, 7158-3167-80, 7158-3168-80
- 4. APPLICABLE UNUSED CAVITY PLUG: 7158-3169-40

GENERAL TOLERANCE												ISSUE MARK
	10 MAX	50 MAX	100 MAX	250 MAX	250 OVR	R5 MAX	R10 MAX	R20 MAX	R20 OVR	ANGLE	ECCENT	
A	±0.15	±0.2	±0.3	±0.5	±0.75	±0.2	±0.3	±0.5	±2.5	±3°	0.1	
B	±0.2	±0.3	±0.55	±0.95	±1.4					±3°	0.1	
C	±0.3	±0.5	±0.8	±1.4	±2					±3°	0.15	

				CUSTOMER				MATEL. SPEC.				TREAT. & FIN.	
				CUSTOMER PART NO.				CUSTOMER DWG NO.				NAME	
2017/06/22				NEW				C17-Z207				HS 025 6P SEALED	
LET				REVISION RECORD				TRIAL PART NO.				SUB ASSEMBLY FEMALE (OBD)	
DATE				NO.				VENDOR				PART NO. 7289-9553-30 ETC.	
GENERAL TOLERANCE				VENDOR NO.				DWG SOURCE				DWG NO. 7289-9553-30:R	
10MAX				DWG TYPE				DWG DATE				SET DWG NO.	
50MAX				R				2017/06/22				YAZAKI CORPORATION	
100MAX				APPROVED				DESIGN					
250MAX				CHECKED				DRAWN					
250OVR				T. MIYAKAWA				A. QUIROL					
ANGLE				2017/06/22				2017/06/22					
ECCENT				2017/06/22				2017/06/22					
A ±30'				2017/06/22				2017/06/22					
B ±30'				2017/06/22				2017/06/22					
C ±30'				2017/06/22				2017/06/22					
SPECIFIED				MASS									